

## SE-A355Z



- Innovative, high efficient mixed flow fan
- Jet-engine design, precisely calibrated, aerodynamics refined through CFD optimization
- Eco-watt technology, 3-phase, 6-pole brushless motor
- Certified: CE,UKCA,ETL,SAA,PSE,G-mark

## GENERAL DATA

Model	SE-A355Z
Fan Size	14inch/355mm
Net Weight	11.5KG
Rated Voltage	220~277VAC
Max. Power C	550W
Frequency	50/60Hz
Max. Speed	3000RPM
Max. Airflow	2570CFM/4369M <sup>3</sup> H
Max. Static P	73mmH <sup>2</sup> O/716Pa
Max.Noise L	80dBA
IP Rating	IP65
Housing	Painted Metal
Motor Type	EC Motor

## PQ Curve

Name	Value	Unit
Volume flow	4369	M <sup>3</sup> /H
Pressure	716	Pa

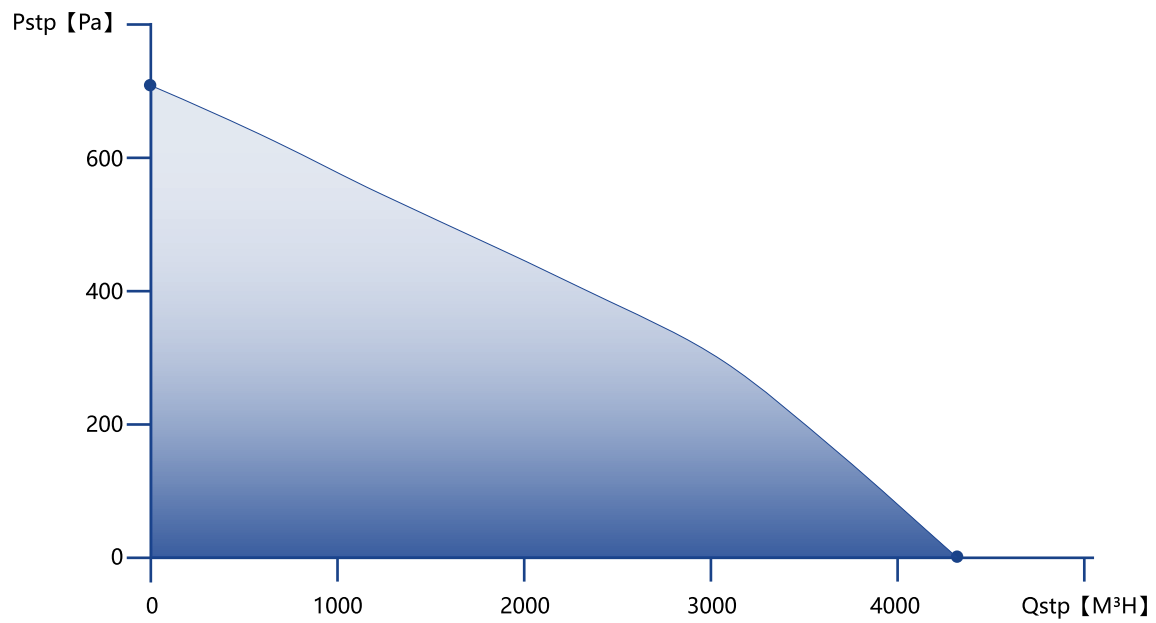

# DIMENSION DRAWING

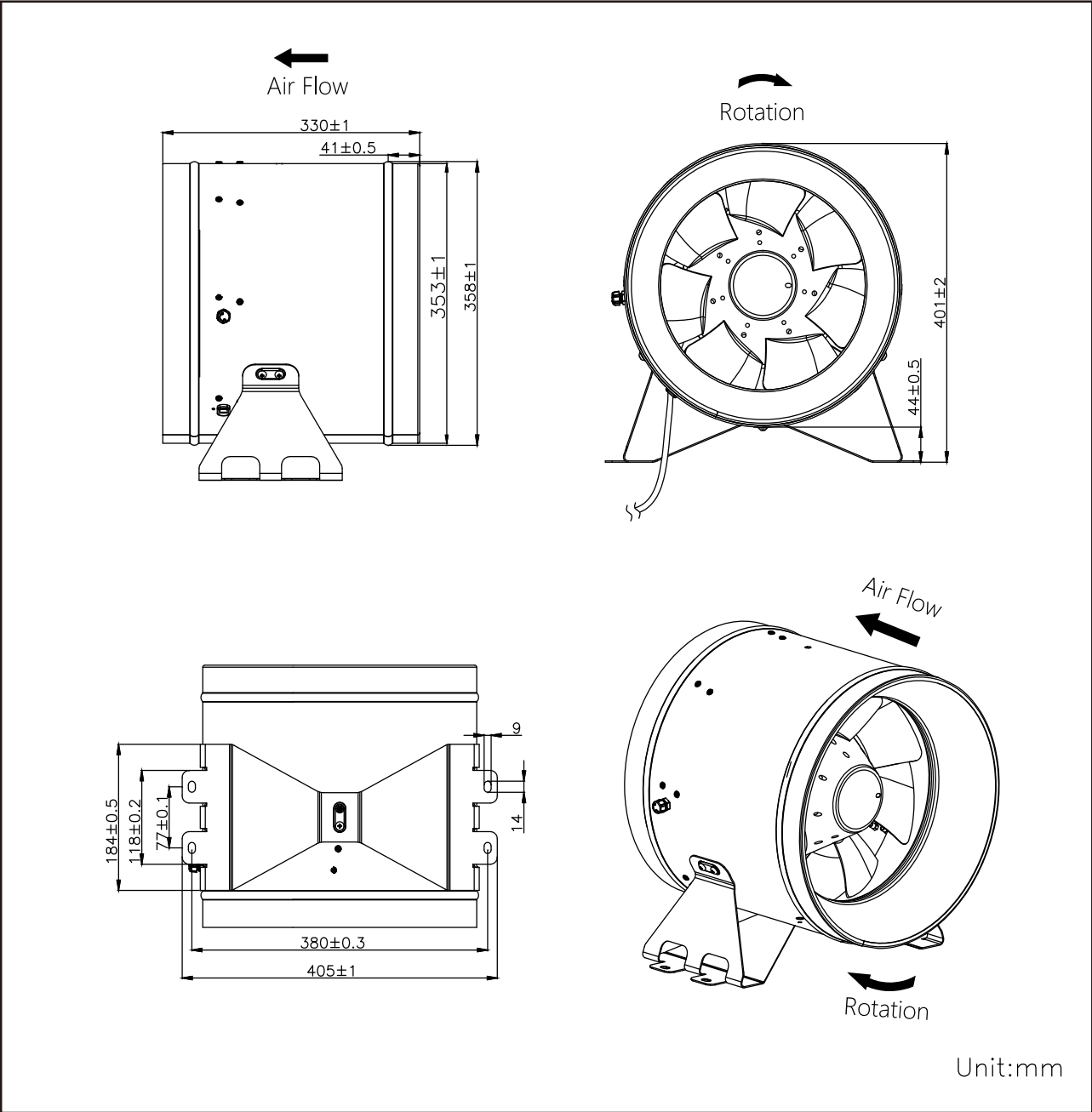

# DIY 4-PINS CONTROL

EC fan with Multiple Speed Control Signals is packed with a DIY 4 pins connection cable, please refer to the diagram below.

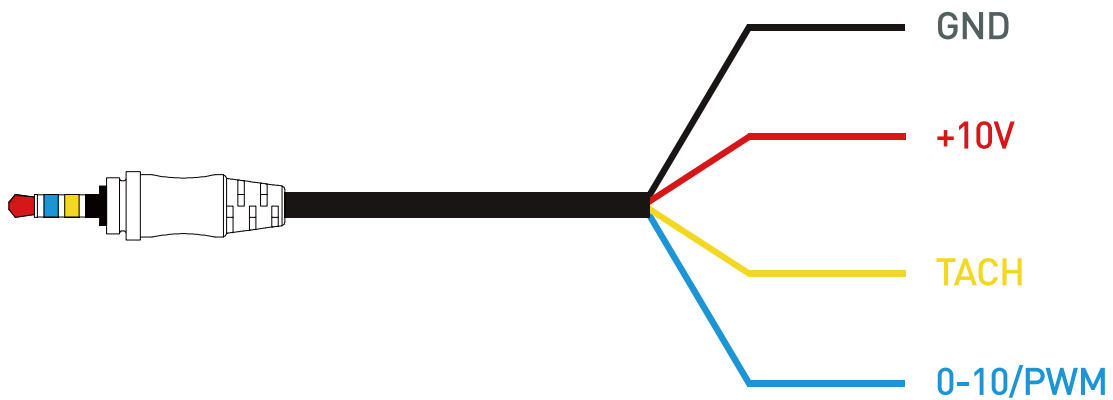

**Speed Control via 0-10V**

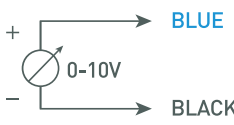

**Max.Speed**

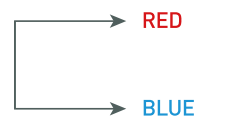

**Speed Control via PWM**

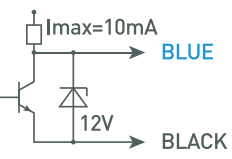

**Speed Control via POT**



# ACCESSORIES

■ Smart EC fan controller pro



■ Temperature controller



■ Wall mounted controller



■ Wireless remote with receiver



■ Wall mounted controller (US)



■ Varibale speed controller



■ Extension Control cable



■ DIY Speed Control Cable



■ 3 Pins Controller Adaptor



■ RJ45 Controller Adaptor



# WALL MOUNTED INSTALLATION

1. Mark the screw position on the wall

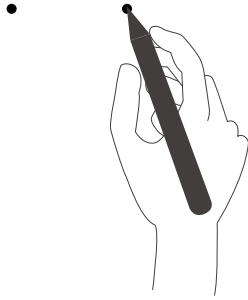

2. Punch holes in the wall



3. Screw the fan onto the wall

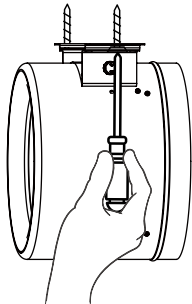

4. Connect the ducts on two sides with clamps

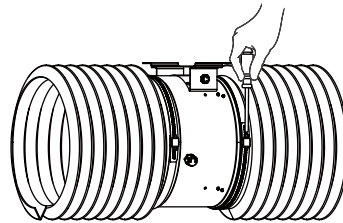

5. Connect the speed control to the fan and make sure the connection is in place and fastened

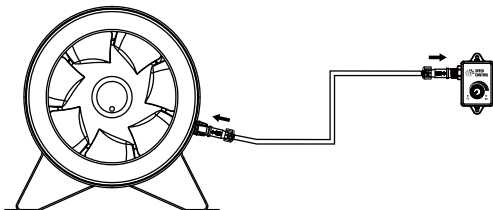

6. Power up the fan

